

IM480 – Loading (Installing) Rates

The following condition must be met before loading rates:

- The customer must have a rate protection plan.
- The machine must be declared.

Loading (Installing) Rates:

1. Press the “MENU” button.

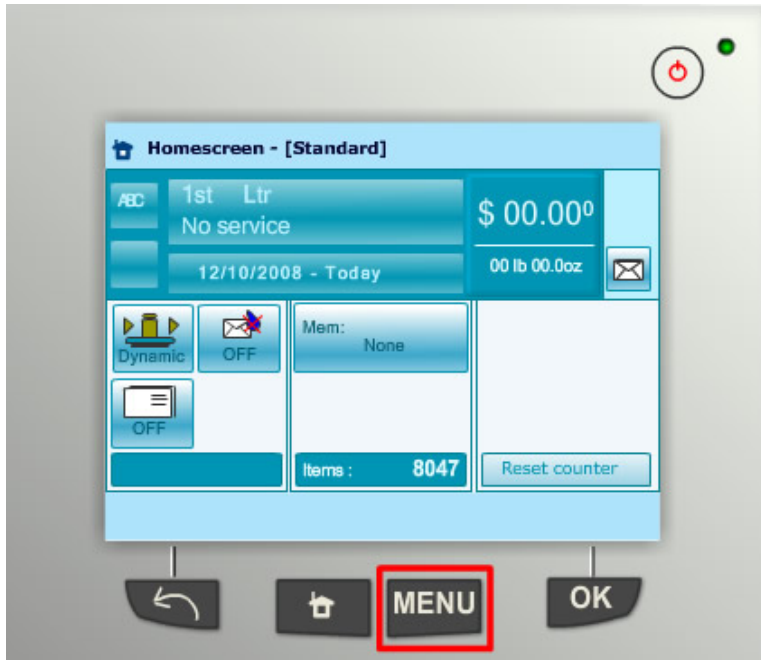

2. Touch “Next Items”.

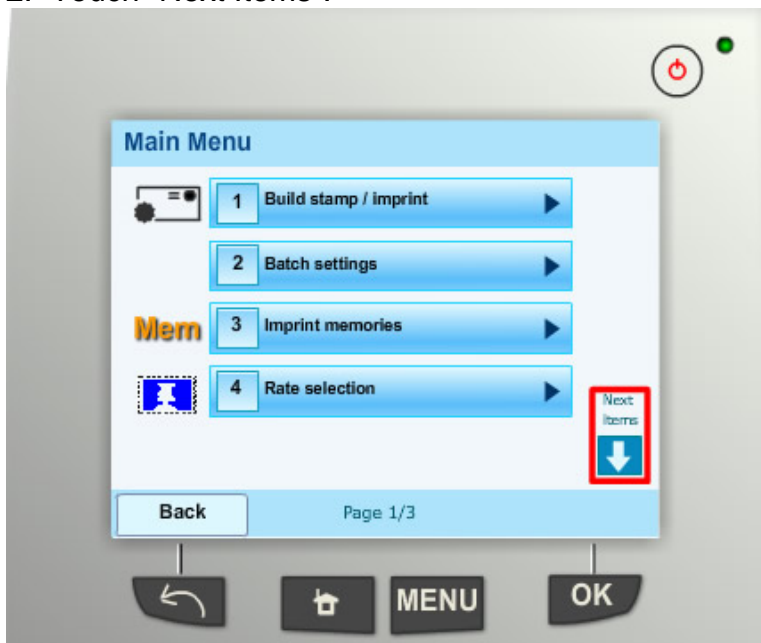

3. Touch "Next Items".

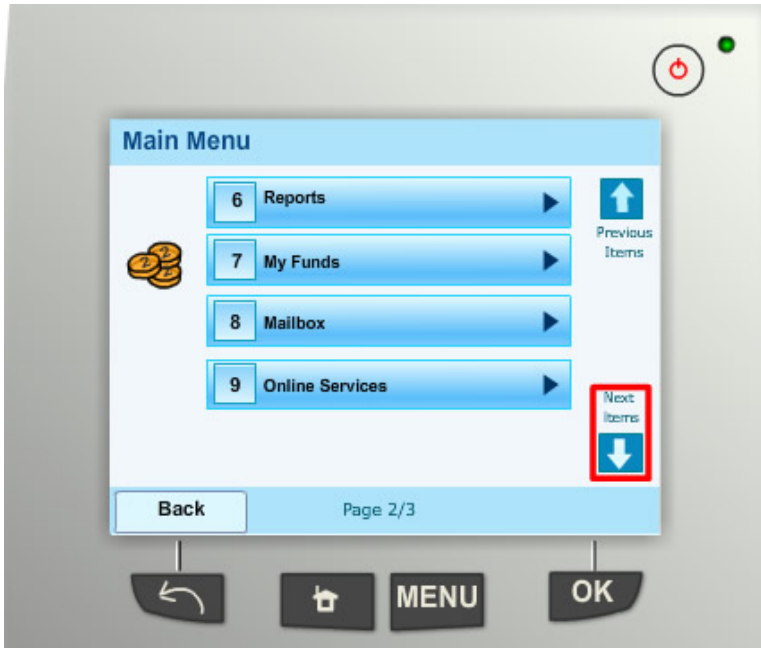

4. Select "Supervisor".

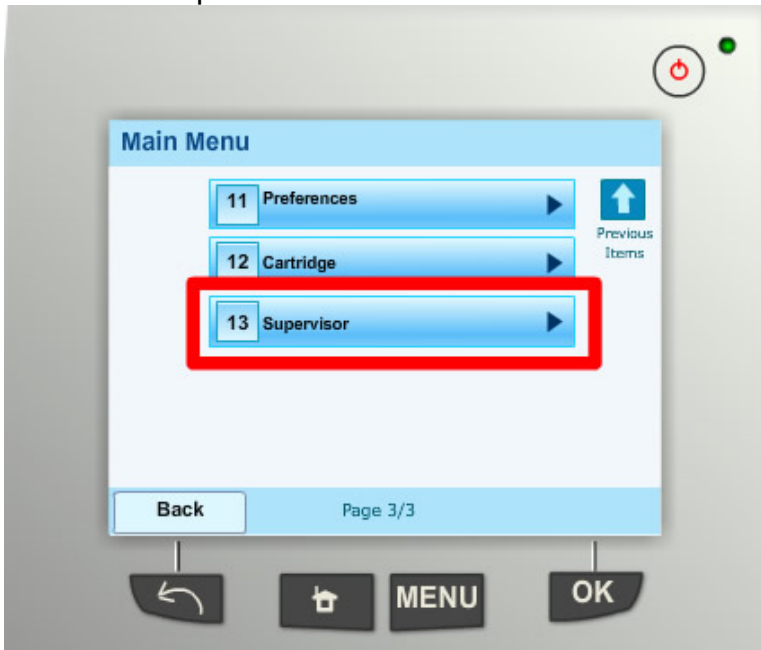

5. Enter the Supervisor PIN Code using the alphanumeric keypad.
 - The Supervisor PIN Code is "09430".
 - Once the PIN Code is entered touch or press "OK".

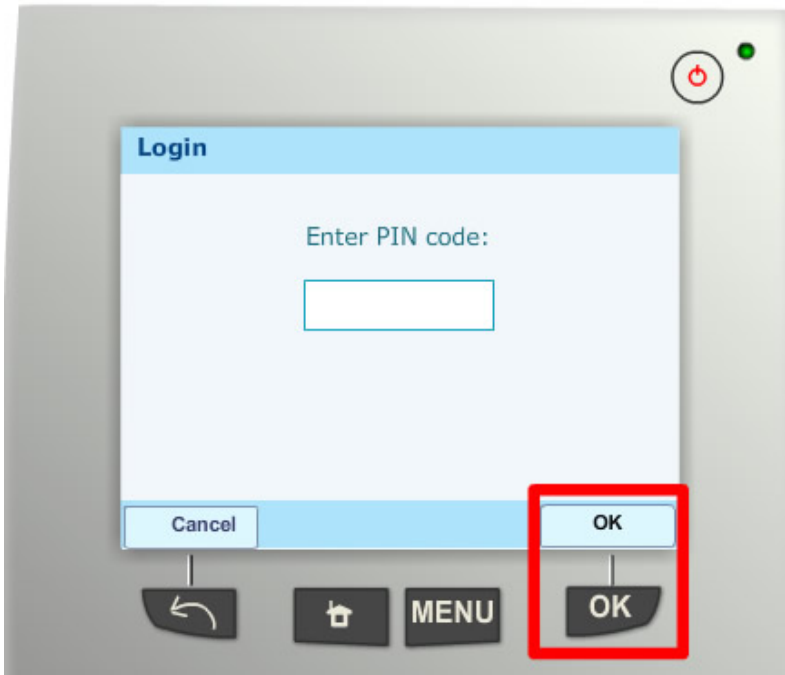

6. Touch "Next Items".

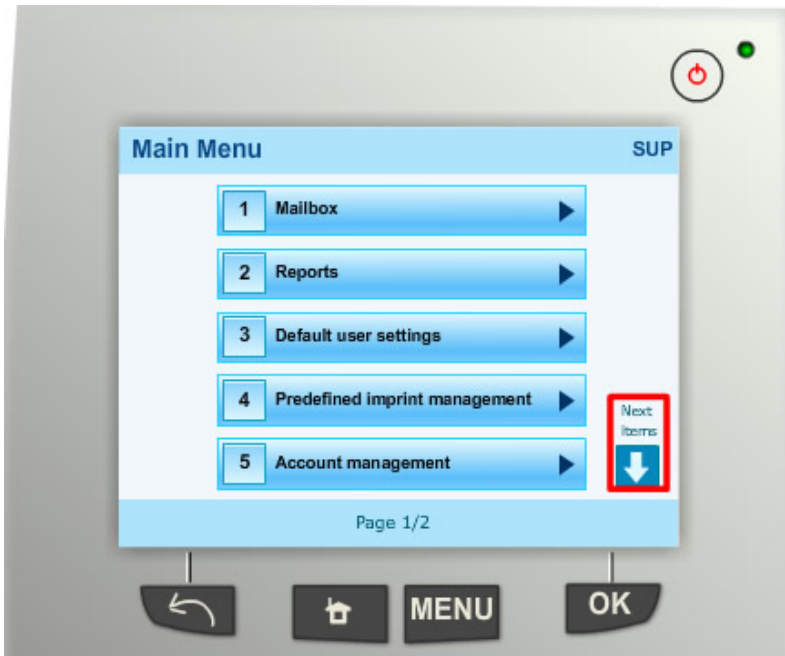

7. Select "Options and Updates".

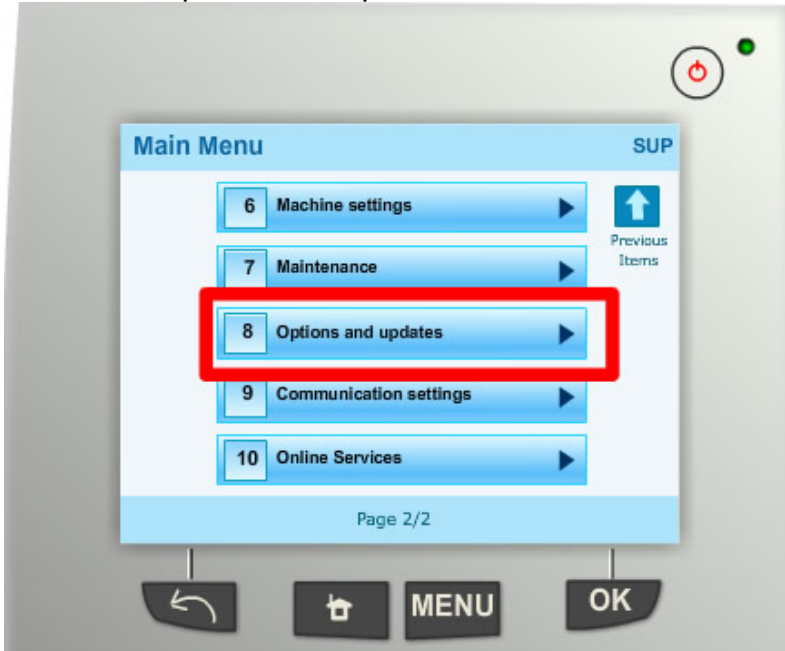

8. Select "Rate Management".

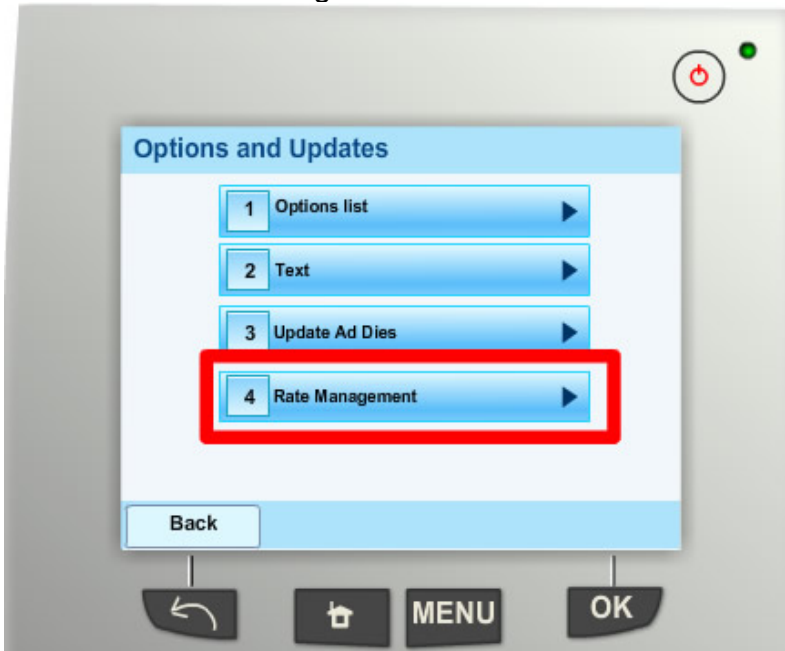

9. Touch "Check for updates".

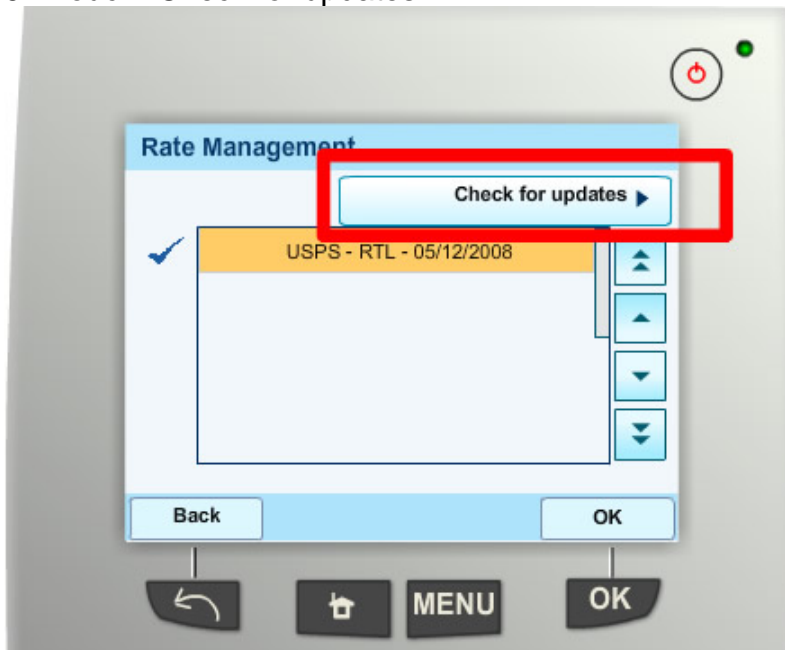

10. The server call consists of:

- Preparing for the call
- Dialing the call
- Transaction in progress

DO NOT INTERRUPT THIS PROCESS.

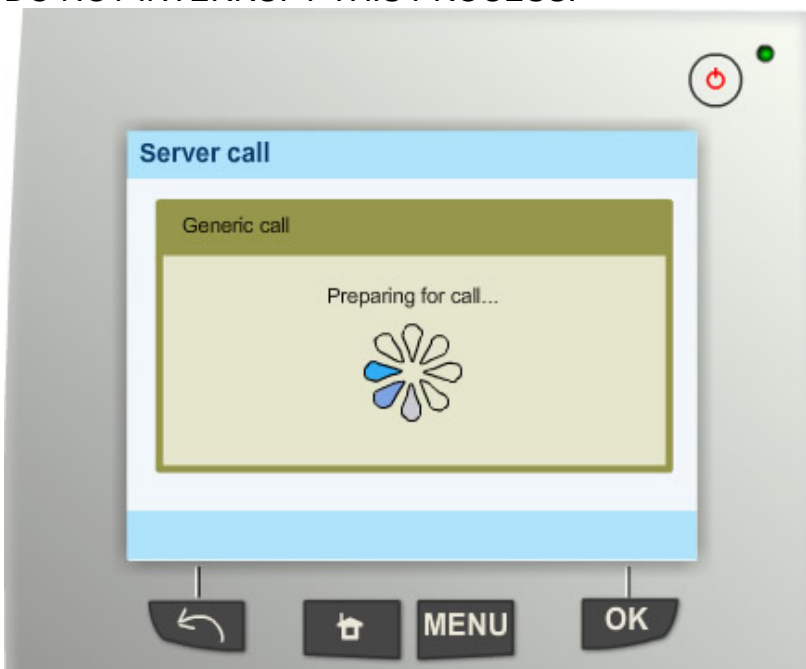

11. The server call finished successfully. Touch or press "OK".

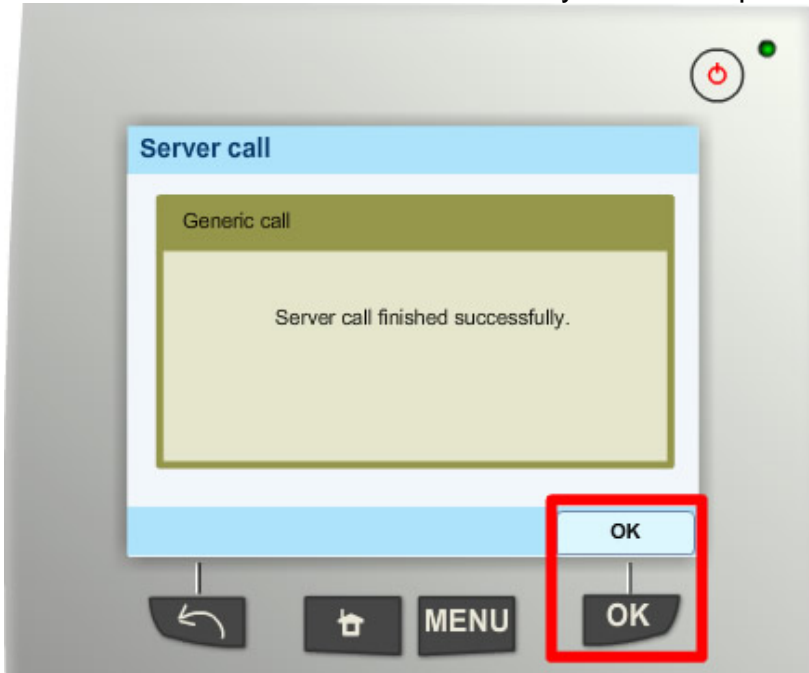

12. Touch or press "OK" to return to the Homescreen.
- The new rates will become active on the effective date. The current rates are indicated by the check mark.

